

Carthane Mexico

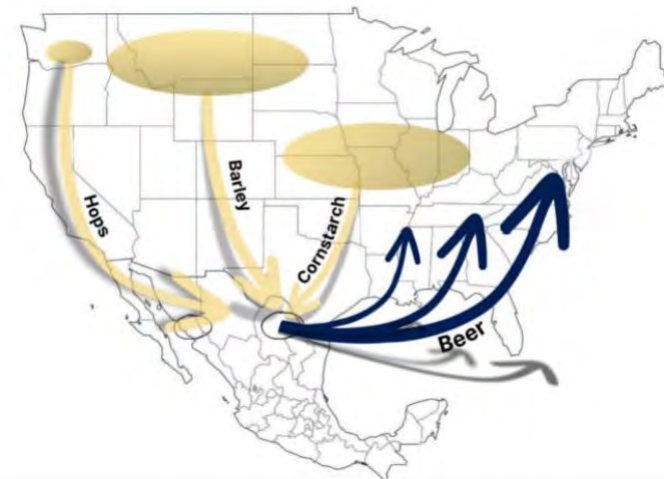

Driving Innovation, Automation, and Resilance in North America

- North American Hub
- Located in Apaseo el Grande, Gto. Our plant is the USMCA strategic center for Carthane.
 - Just-In-Time Logistics for the Bajío Region.
 - Regional Value Content above the 75%.
 - Tech support direct to Mexico and Detroit, MI.

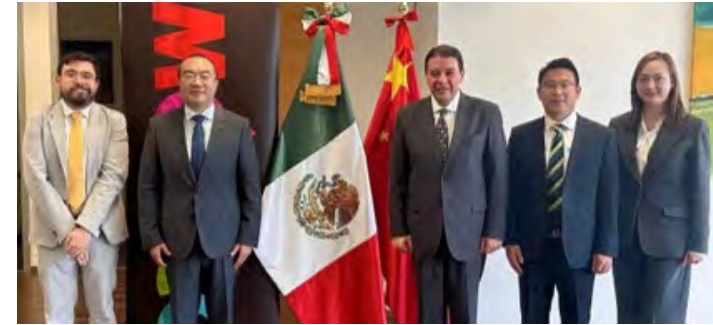

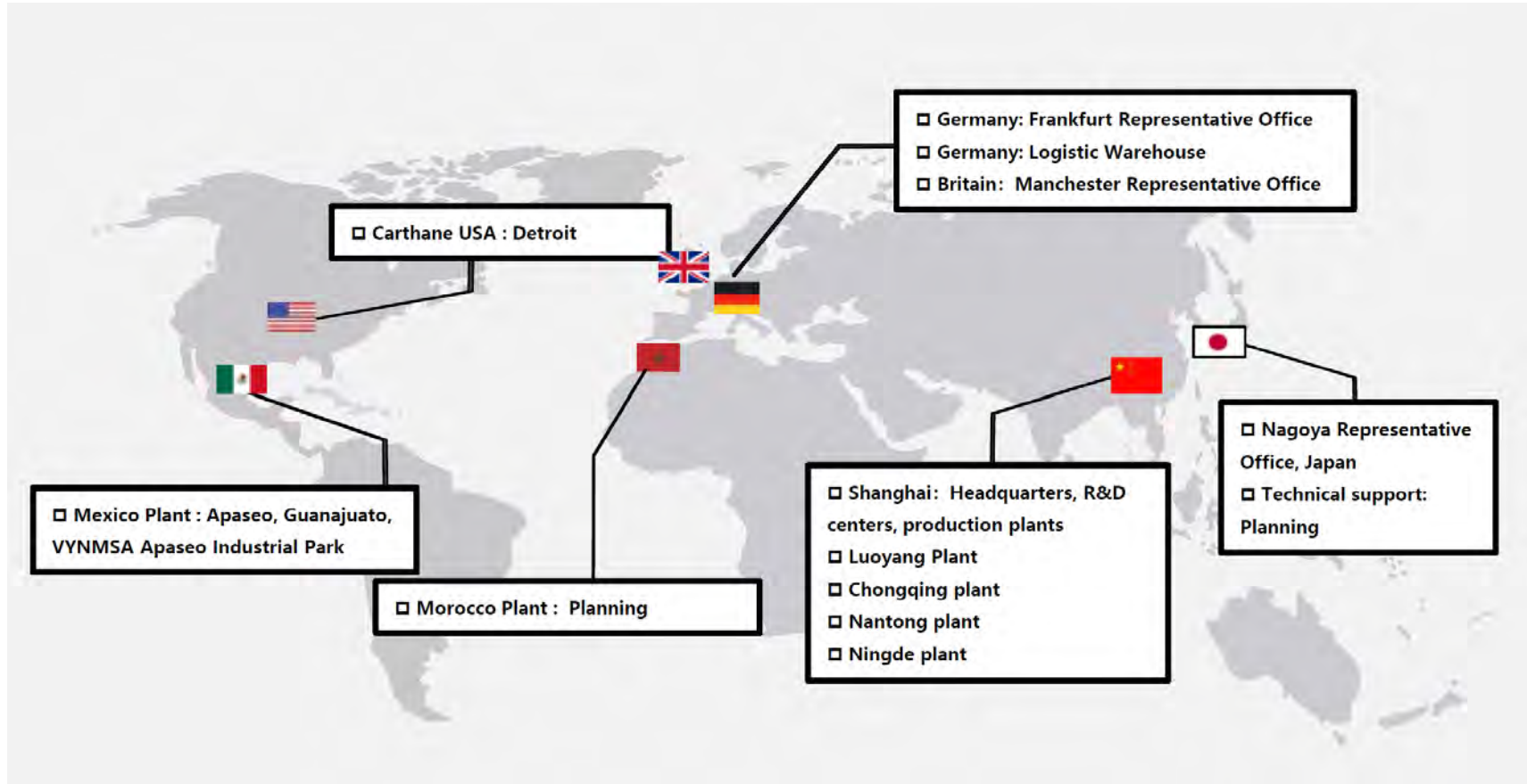

The key is not just a supplier, but a strategic partner with digital tracking and robust automation processes that guarantee USMCA compliance and regional cost efficiency. DUNS 95-16556-554

- Projected income (176M USD) reflecting constant reinvestment in technology and regional expansion.

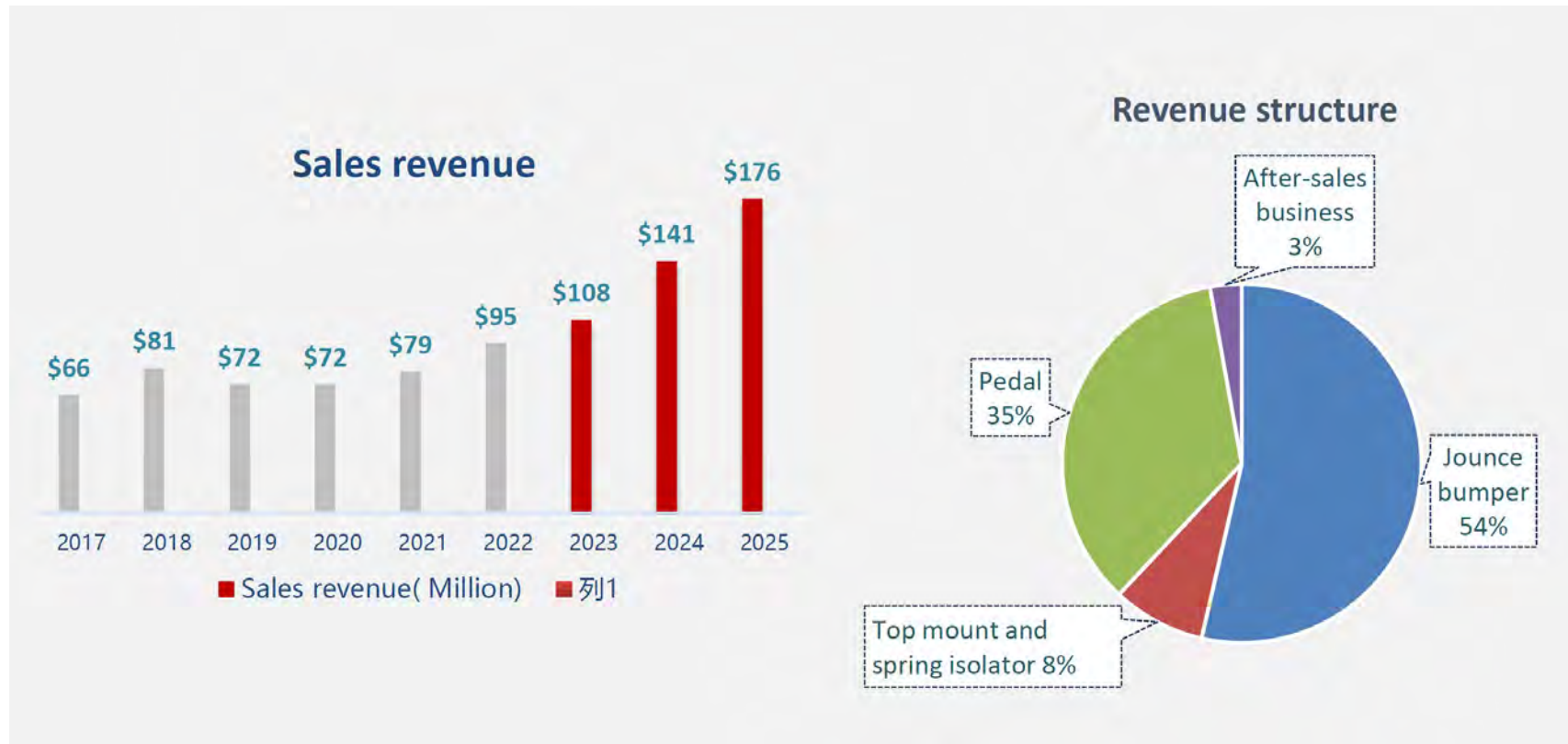

Product Portfolio

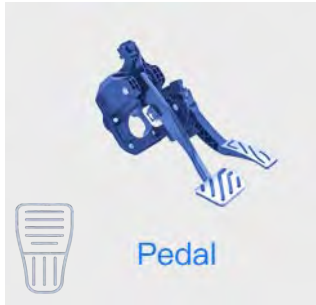

Lightweight structure, electronic sensors ensuring reliability achieving fuel efficiency and sustainability.

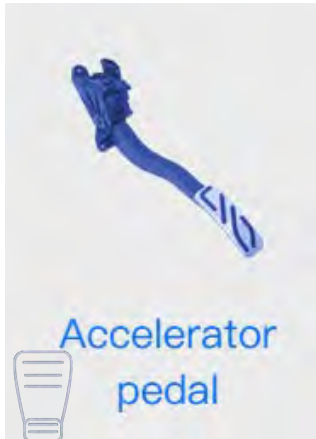

Redundant CAN-bus communication sensors ensuring reliability and seamless integration with modern vehicle systems.



Global leader in MCU bonding technology for superior NVH isolation in EVs and high-performance vehicles.

Core Competences



World-Class Manufacturing Facility

State-of-the-art plant with Top-level automation and modular robotic cells



Quality & Traceability Systems

100% End-of-Line testing with QR-based real-time traceability for every component



Certified Excellence

IATF 16949:2016, ISO 14001/45001 certified, Tisax



Just-in-Time Logistics

Optimized delivery systems for OEM and T1 plants, ensuring seamless supply chain integration



Regional Value Content

Exceeding 75% RVC threshold, ensuring full USMCA compliance and tariff-free trade advantages



Technical Support Hub

Direct engineering support for facilities in Mexico and Detroit with rapid response capabilities



Strategic Location

Central position in Guanajuato's automotive corridor, optimizing logistics for North American OEMs



IATF 16949



ISO 14001:2015



ISO 45001:2018



Mercedes-Benz

LUCID



Mexico layout

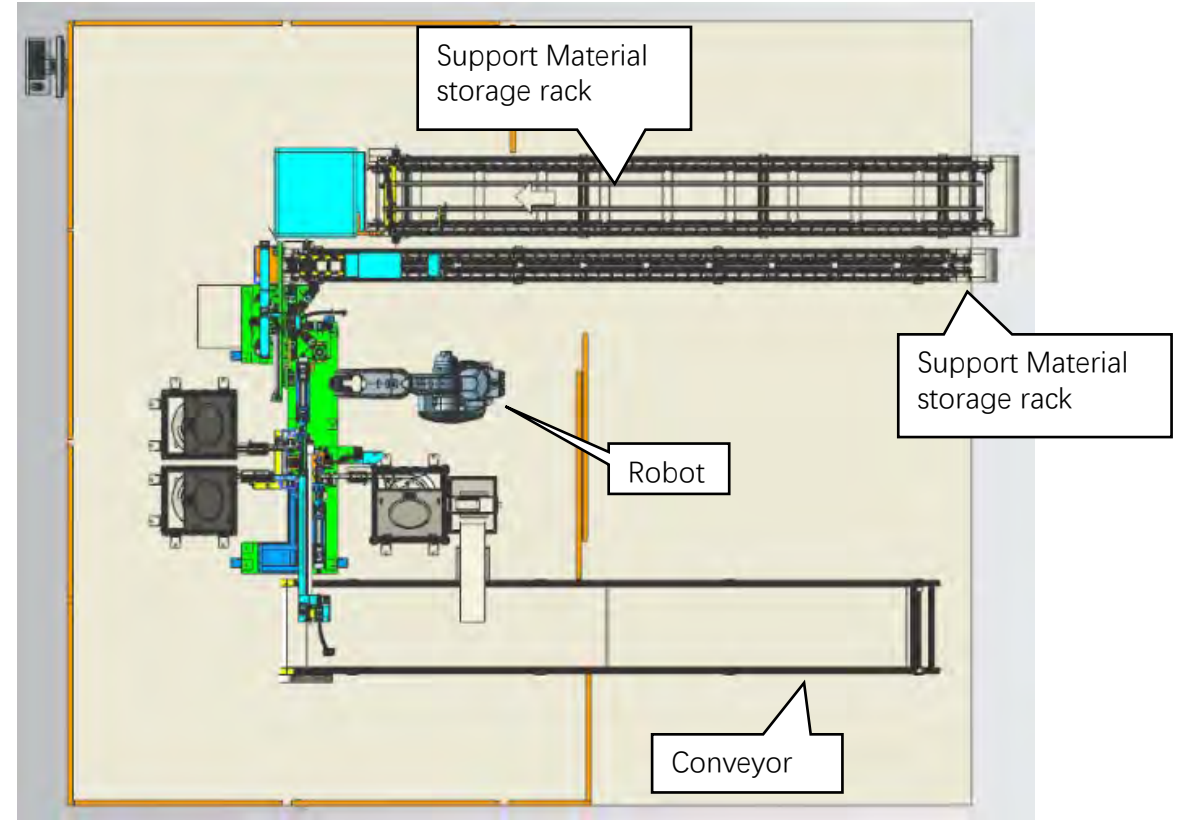
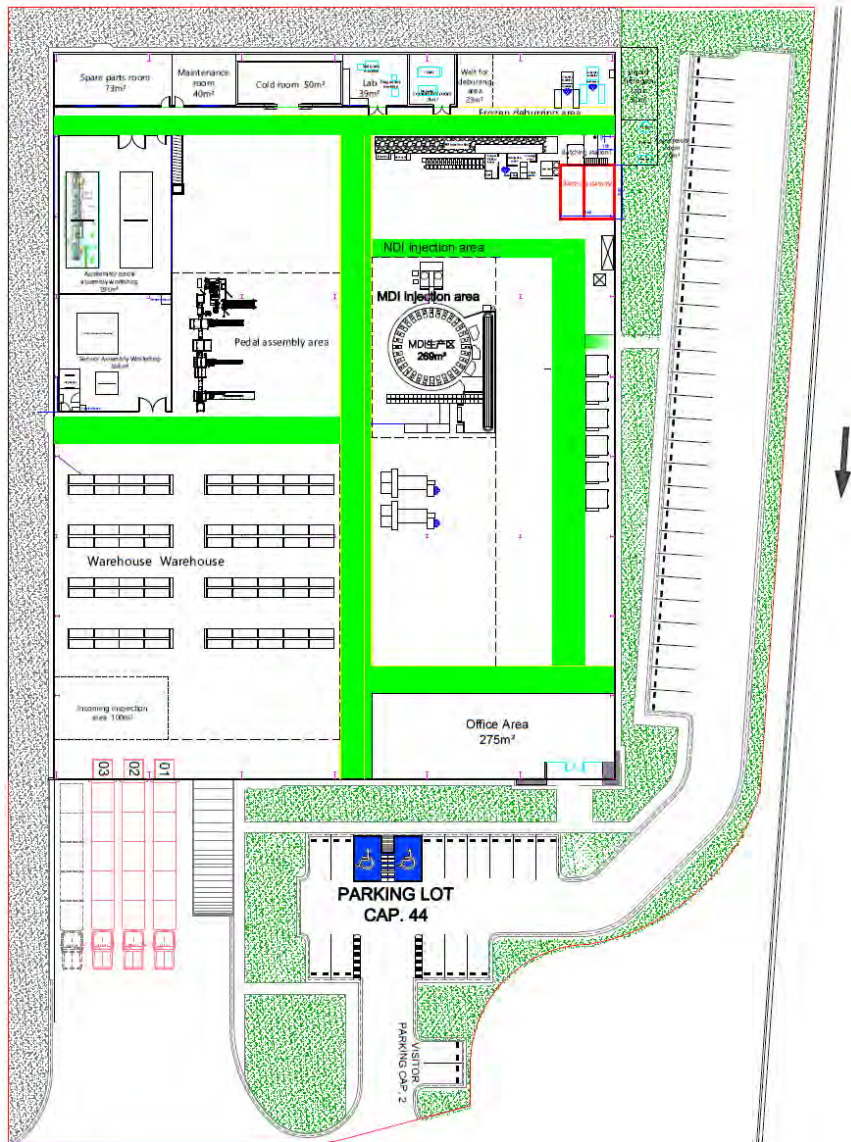

Process flow chart.

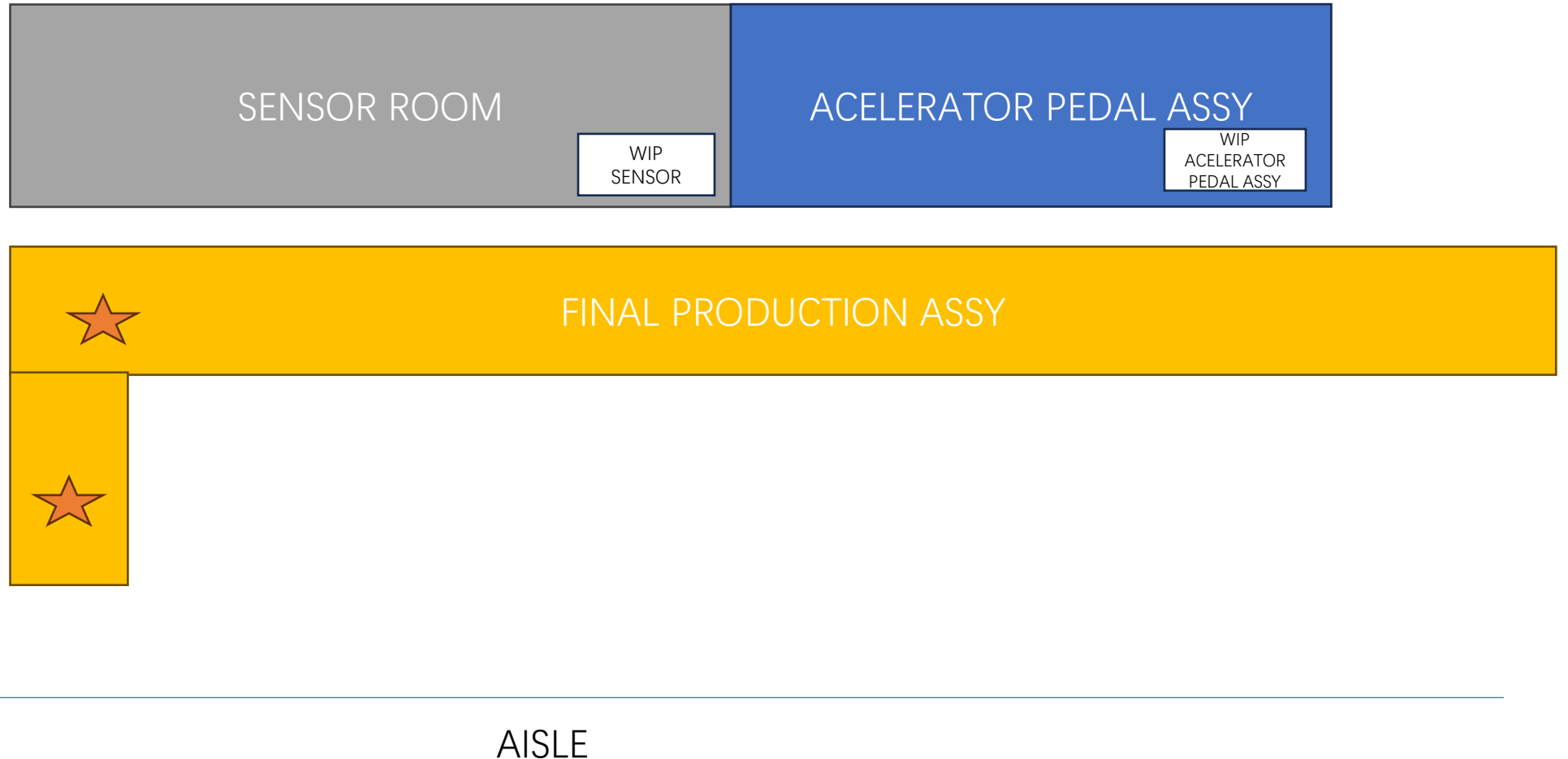

- To complete 1 single part the production line is separate in 3 section that Works independiente each other.
- Each start in the sketch represent the scan points were the databases get information.

Process flow chart.



Process flow PTS.

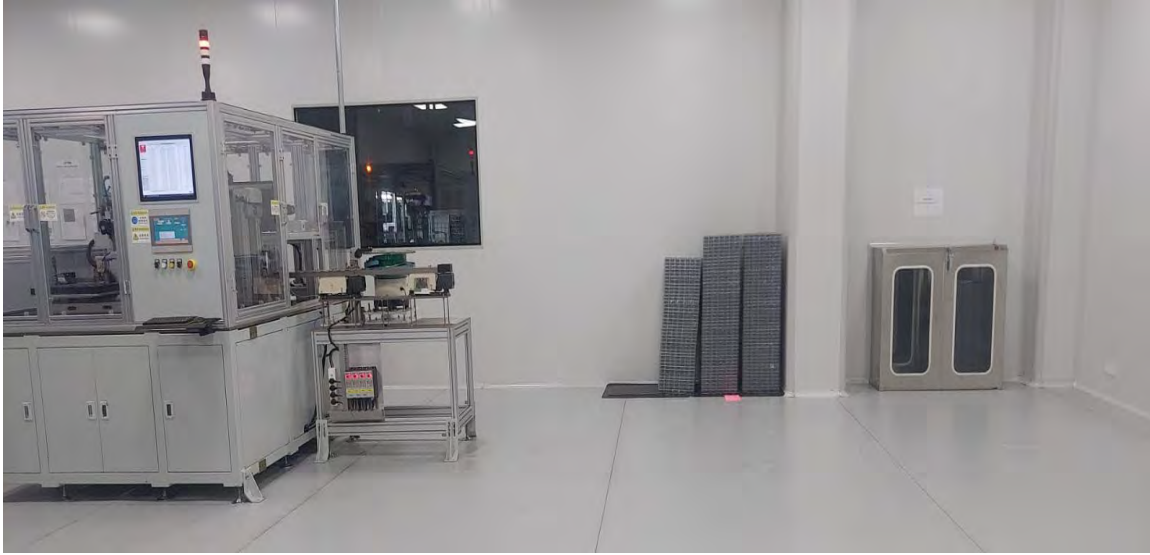

Operator has the task load the components in the feeders

1. PCBA
2. HOUSING
3. PCBA COVER
4. MAGNET COVER
5. Download the basket once is completed, and place the empty basket.

If the assy is OK QR code is printed,



Automatically assembly process



OP10 Bushing insert and press



pedal assy



OP50 Gas pedal assy



OP60-2 EOL



OP20 Bushing checks



OP40 PTS assy



OP60-1 EOL



OP70 Marking



Automatic Assembly Line for Tesla Brake Pedals

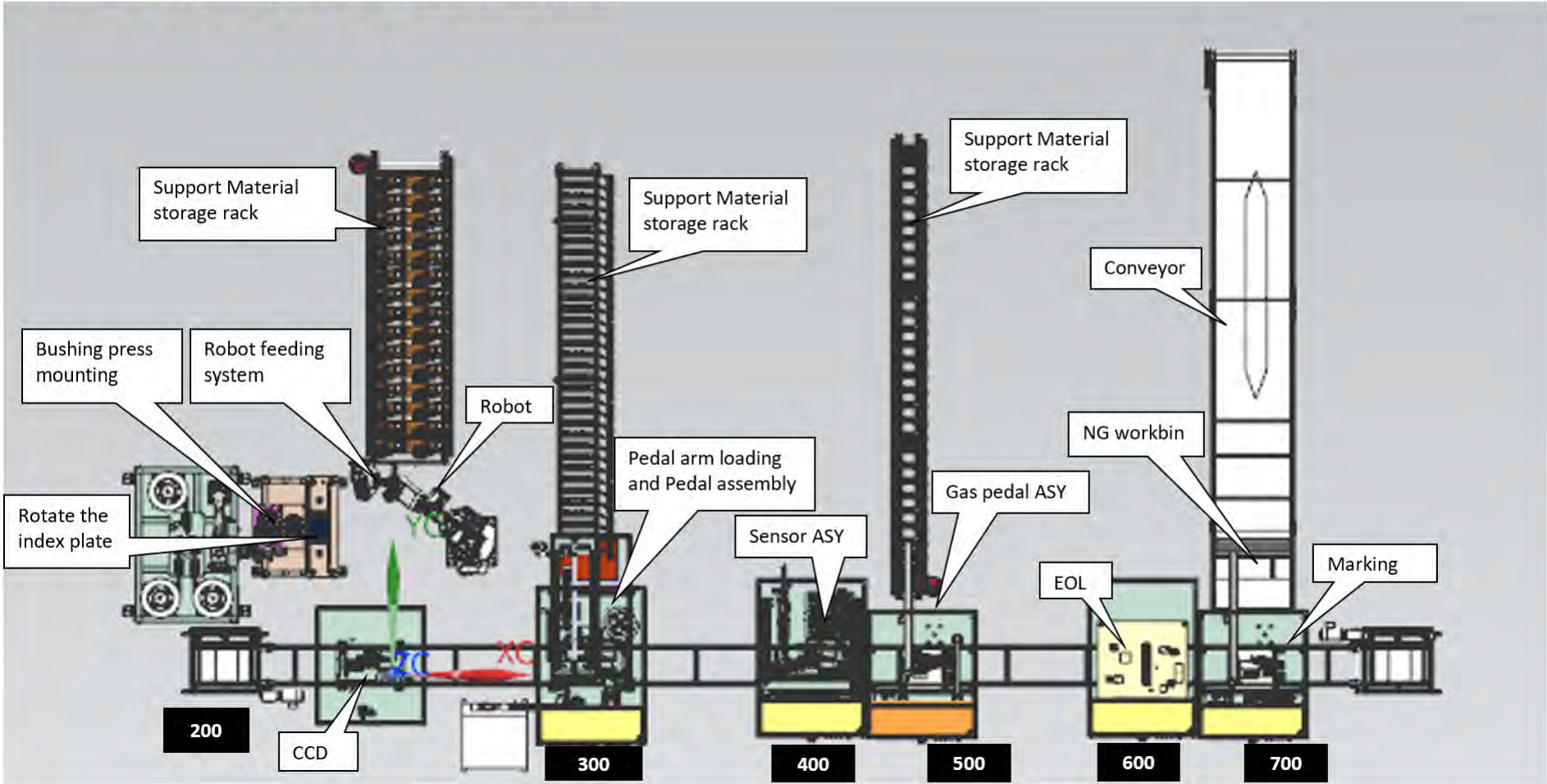

Traceability Systems

Equipo
Calidad

Machine Information

Machine	Personnel	Tools	Achieved	Yield	Bad Qty
GP(GP12)	1	0	0%	99.7%	1
NDI AERA 01(NDI 01)	2	0	0%	0%	0
NDI AERA 02(Cryogenic deflashing 01)	0	0	0%	0%	0
NDI AERA 08(NDI INSP 1)	1	1	0%	0%	0
NDI AERA 11(NDI INSP 2)	1	0	0%	0%	0
NDI BATCHING 01(NDI BATCHING)	1	0	0%	0%	0
PEDAL AERA 01(APM sensor Line01)	0	4	0%	0%	0
PEDAL AERA 02(PTS Line 01)	0	4	0%	0%	0
PEDAL AERA 03(APM Line 01)	1	4	0%	100%	0
PEDAL AERA 04(PEDAL ASM)	1	19	0%	0%	1

Material On Machine

Production Information

Product Name.: TSL01-300000-02
 Product No.: 05.05.03.0303
 WO No.: 109-MO202605154996
 Lot No.: 109-MO202605154996-001
 Lot Qty: 629
 Next: Close FGD
 Completion Ratio: 96%
 Produced Qty: 601
 Produced Good Qty: 600
 Total Defect Qty: 1

On-Duty
Off-Duty
Off-Duty All
Cutting
Machine Check

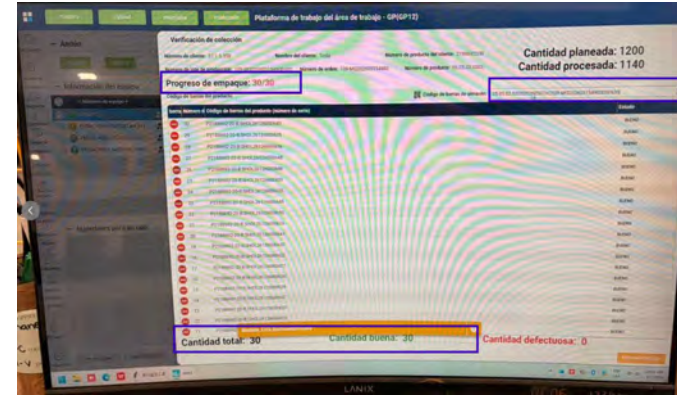

Product Traceability

Producto (ProductNo): 05.05.03.0303 Cliente (CustomerLabel):

Serial/ID No	Material Code/ProductNo	Material Name/ProductName	WMS Label/WMSLabel	Customer Label/CustomerLabel	Comparison Result/ComparisonResult	Time/Time
109-FHTZ2026043616	05.05.03.0303	TSL01-300000-02	05.05.03.0303#20260503#A#C#001#0001#30	D++06.6.000233589260427202446 3338.P21.88692-20- B:Q30K7700020046.5K-4K20.3QEA; T:1501.12D-99ZP20260510.5.XD+*	校验成功	2026-05-11 13:19:09
109-FHTZ2026043616	05.05.03.0303	TSL01-300000-02	05.05.03.0303#20260503#A#C#001#0001#30	D++06.6.000233589260427202446 3338.P21.88692-20- B:Q30K7700020046.5K-4K20.3QEA; T:1501.12D-99ZP20260510.5.XD+*	校验成功	2026-05-11 11:27:16
109-FHTZ2026053997	05.05.03.0303	TSL01-300000-02	05.05.03.0303#20260505#A#C#09-MO202605154996#0001#30	D++06.6.000233589260506050217 1331.P21.88692-20- B:Q30K7700020046.5K-4K20.3QEA; T:1501.12D-99ZP20260510.5.XD+*	校验成功	2026-05-08 20:00:57
109-FHTZ2026053997	05.05.03.0303	TSL01-300000-02	05.05.03.0303#20260505#A#C#109-MO202605154996#001#30	D++06.6.000233589260506050217 1425.P21.88692-20- B:Q30K7700020046.5K-4K20.3QEA; T:1301.12D-99ZP20260510.3.XD+*	校验成功	2026-05-08 20:00:40
109-FHTZ2026053997	05.05.03.0303	TSL01-300000-02	05.05.03.0303#20260505#A#C#109-MO202605154996#001#30	D++06.6.000233589260506050217 1515.P21.88692-20- B:Q30K7700020046.5K-4K20.3QEA; T:1501.12D-99ZP20260510.5.XD+*	校验成功	2026-05-08 20:00:23
109-FHTZ2026053997	05.05.03.0303	TSL01-300000-02	05.05.03.0303#20260506#A#C#09-MO202605154996#001#30	D++06.6.000233589260506050217 3249.P21.88692-20- B:Q30K7700020046.5K-4K20.3QEA; T:1501.12D-99ZP20260510.5.XD+*	校验成功	2026-05-08 19:57:07
109-FHTZ2026053997	05.05.03.0303	TSL01-300000-02	05.05.03.0303#20260505#A#C#109-MO202605154996#001#30	D++06.6.000233589260506050217 4610.P21.88692-20- B:Q30K7700020046.5K-4K20.3QEA; T:1501.12D-99ZP20260510.5.XD+*	校验成功	2026-05-08 19:56:56
109-FHTZ2026053997	05.05.03.0303	TSL01-300000-02	05.05.03.0303#20260505#A#C#109-MO202605154996#001#30	D++06.6.000233589260506050217 4068.P21.88692-20- B:Q30K7700020046.5K-4K20.3QEA; T:1301.12D-99ZP20260510.3.XD+*	校验成功	2026-05-08 19:56:45
109-FHTZ2026053997	05.05.03.0303	TSL01-300000-02	05.05.03.0303#20260505#A#C#109-MO202605154996#004#30	D++06.6.000233589260506050217 4878.P21.88692-20- B:Q30K7700020046.5K-4K20.3QEA; T:1501.12D-99ZP20260510.5.XD+*	校验成功	2026-05-08 19:56:33
109-FHTZ2026053997	05.05.03.0303	TSL01-300000-02	05.05.03.0303#20260505#A#C#109-MO202605154996#005#30	D++06.6.000233589260506050217 4788.P21.88692-20- B:Q30K7700020046.5K-4K20.3QEA; T:1501.12D-99ZP20260510.5.XD+*	校验成功	2026-05-08 19:56:20



One unique box label was create to identify the material in production
One unique box label is créate for CS1 station, the process were identify in system as GP

Both labels are printed automatically after 30 pieces OK has been scanned

Automation Excellence

Tesla-level automation systems ensuring zero-defect manufacturing with advanced monitoring and scalable robotic solutions.

Standardized critical processes across all assembly lines for OEM Capability



Zero-Error CCD Vision

CCD vision ensuring 100% defect detection accuracy



Force/Displacement Monitoring

Precision monitoring for bushing pressing operations



Modular Robotic Cells

Flexible production with independent modular sections

Quality controls

- EOL Testing
- All the produced pieces are automatically tested for function, relative position, visual inspection, information before the packing.

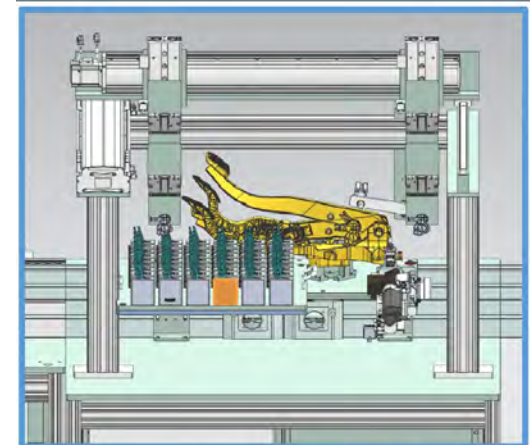
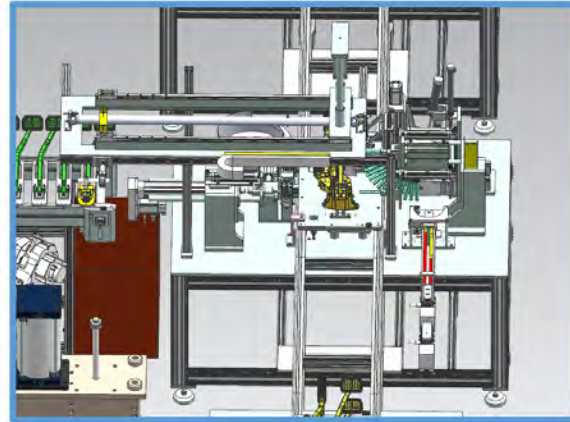

End to End Tracking

- Real time monitor
 - BI systems to link the QR for each component with production history records.
- Scanning in each Critical station.
- Automatic Matching for Customer and inhouse labels.
- Preventive block of materials in quareteene for quality engineers systems.

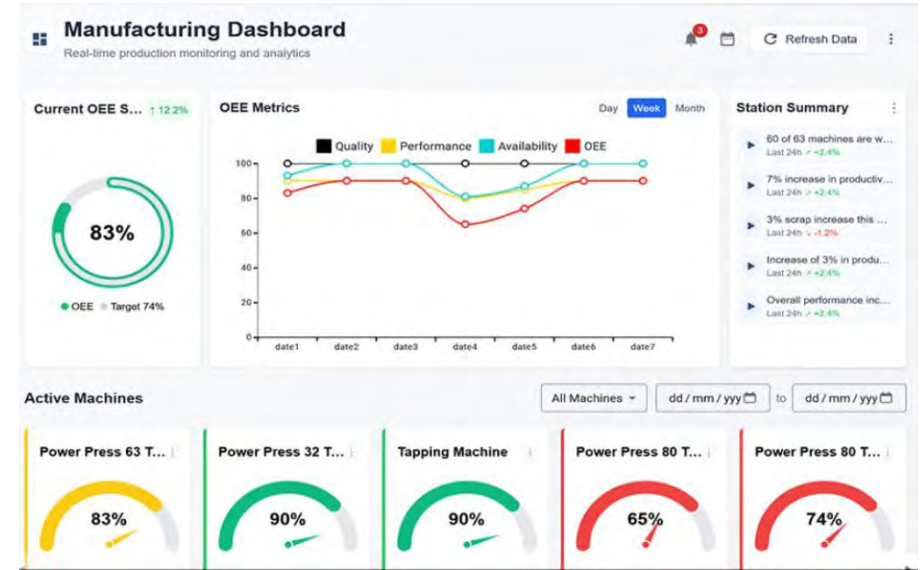

The screenshot shows the LC-WMS system interface with a table of material management data. The table includes columns for 'Base LabelManage', 'Serial No.', 'Barcode', 'Base Spec', 'Base LabelManage', 'Base LabelManage', 'Base LabelManage', 'Origin', 'Column ID', and 'Status'. The data rows show various material units and their corresponding labels and statuses.

Base LabelManage	Serial No.	Barcode	Base Spec	Base LabelManage	Base LabelManage	Base LabelManage	Origin	Column ID	Status
198-MC02289154-996	05-05-03-0303	TSL01-300000-02	制送及檢	Material single bin 1	2026011CB	2026-05-11	Block	198-Carthane Me	禁
198-MC02289154-996	05-05-03-0303	TSL01-300000-02	制送及檢	Material single bin 1	2026011CA	2026-05-11	Issue received	198-Carthane Me	禁
198-MC02289154-996	05-05-03-0303	TSL01-300000-02	制送及檢	Material single bin 1	2026009CB	2026-05-09	The initial	198-Carthane Me	禁
198-MC02289154-996	05-05-03-0303	TSL01-300000-02	制送及檢	Material single bin 1	2026009CB	2026-05-09	The initial	198-Carthane Me	禁
198-MC02289154-996	05-05-03-0303	TSL01-300000-02	制送及檢	Material single bin 1	2026009CB	2026-05-09	The initial	198-Carthane Me	禁
198-MC02289154-996	05-05-03-0303	TSL01-300000-02	制送及檢	Material single bin 1	2026009CB	2026-05-09	The initial	198-Carthane Me	禁
198-MC02289154-996	05-05-03-0303	TSL01-300000-02	制送及檢	Material single bin 1	2026009CB	2026-05-09	The initial	198-Carthane Me	禁
198-MC02289154-996	05-05-03-0303	TSL01-300000-02	制送及檢	Material single bin 1	2026009CA	2026-05-09	Block	198-Carthane Me	禁
198-MC02289154-996	05-05-03-0303	TSL01-300000-02	制送及檢	Material single bin 1	2026009CA	2026-05-09	Block	198-Carthane Me	禁
198-MC02289154-996	05-05-03-0303	TSL01-300000-02	制送及檢	Material single bin 1	2026009CA	2026-05-09	Block	198-Carthane Me	內

Thanks

